



SALAMANDER DESIGNS



UST PROJECTOR INTEGRATED CABINETS

DESIGNED FOR SAMSUNG LPU9D

Seamless Stealthy Solution For Virtually Any Decor

A simple installation with no need to open the wall or ceiling to run cables. All supporting components can be enclosed in the credenza to provide a beautiful and simple solution.



Features:

- Flush top surface, recessed projector cavity design
- Extruded aluminum frame creates a support skeleton
- Pinch-out rear panels to permit fast, easy access to components and wiring
- Wide variety of bolt-on options and accessories are available

Designed for Samsung
Cabinet for Integrated Samsung LPU9D



**Easy to Install
Optional Fan Kit**
prevents heat build-up
with thermostically
controlled fans.

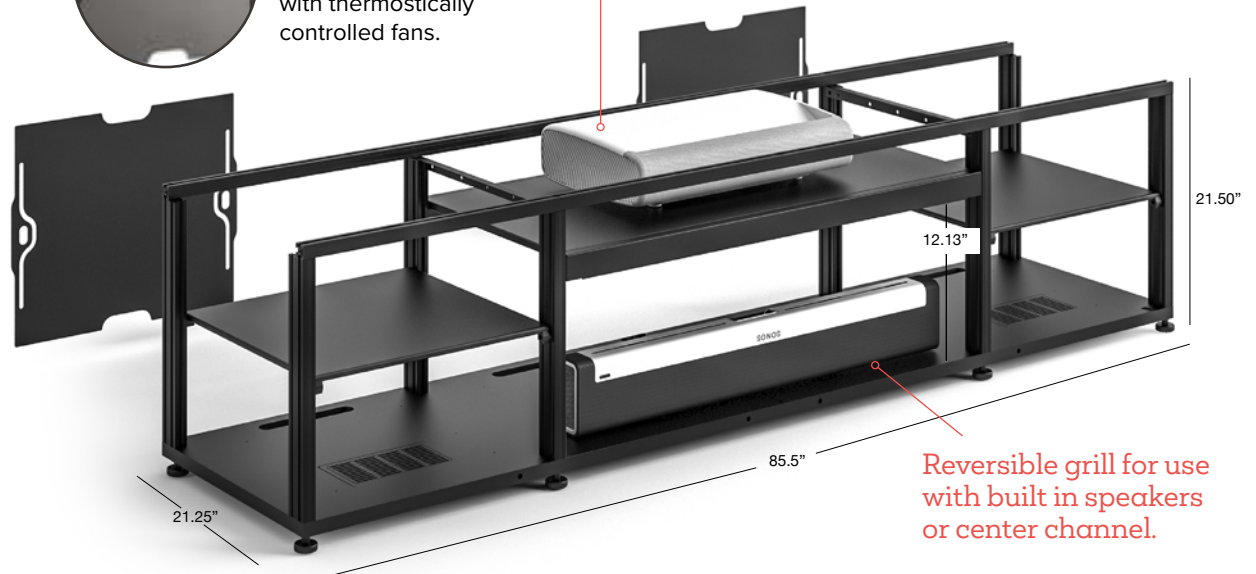

STYLES



**CHICAGO – Black Oak, Grass Texture with
Black Solid Surface Top**
X/SMG9/9D/245CH/BO (LPU9D)



**MIAMI – Gloss, Warm White with
Black Solid Surface Top**
X/SMG9/9D/245MM/GW (LPU9D)



OSLO
X/SMG9/9D/245OS/BG (LPU9D)

Projector Sold Separately

© 2025 Salamander Designs Ltd. SalamanderDesigns.com/samsung | 800.535.9910 | v7.25



MADE IN USA

Salamander Cabinet Designed for Samsung LPU9D Ultra Short-throw Laser Projector

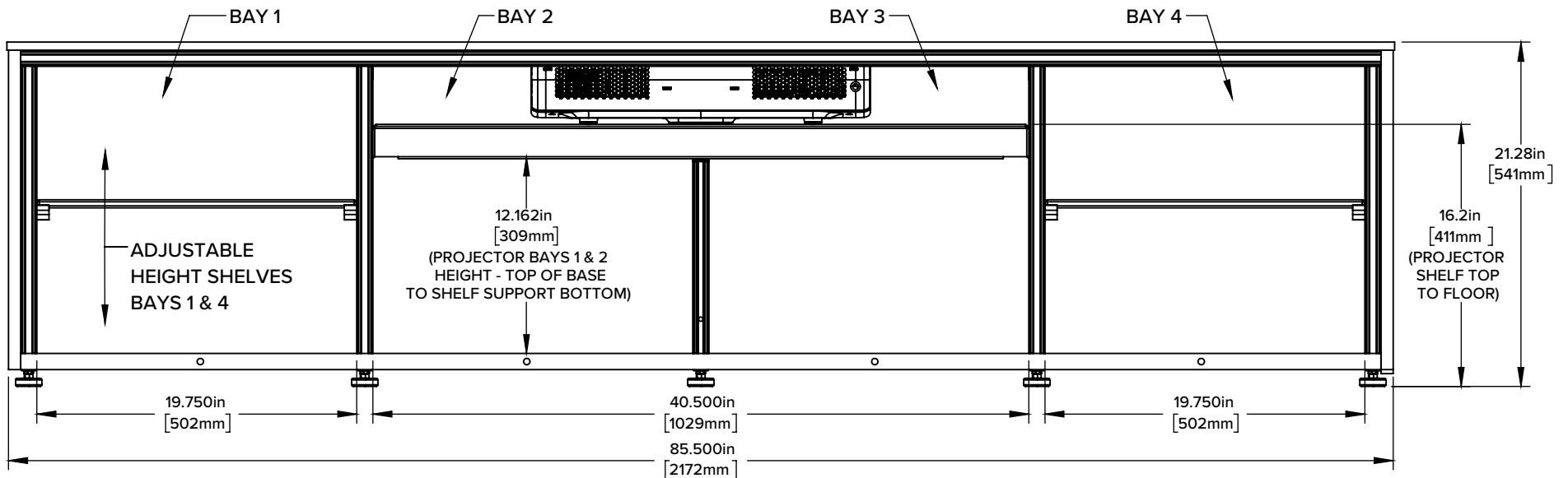
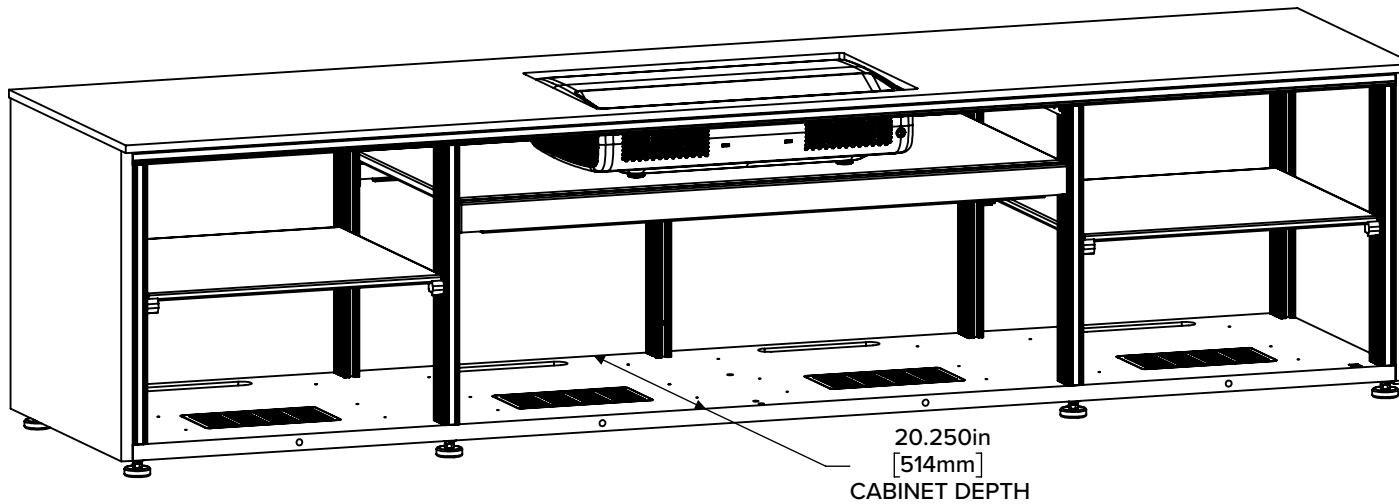

FRONT VIEW
(doors and front panel removed for clarity)

Projector Sold Separately.

© 2025 Salamander Designs Ltd. The information and designs contained in this drawing proprietary of SALAMANDER DESIGNS and may NOT be reproduced. Specifications subject to change without notice.

SalamanderDesigns.com/commercial/samsung | 800.535.9910 | v7.25



Salamander Cabinet Designed for Samsung LPU9D Ultra Short-throw Laser Projector

Diagonal Image	A	B	C
100"	6.35in [161mm]	29in [737mm]	78in [1981mm]
120"	9.44in [231mm]	31in [787mm]	90in [2286mm]
150"	10.94in [278mm]	32.5in [825mm]	96in [2438mm]

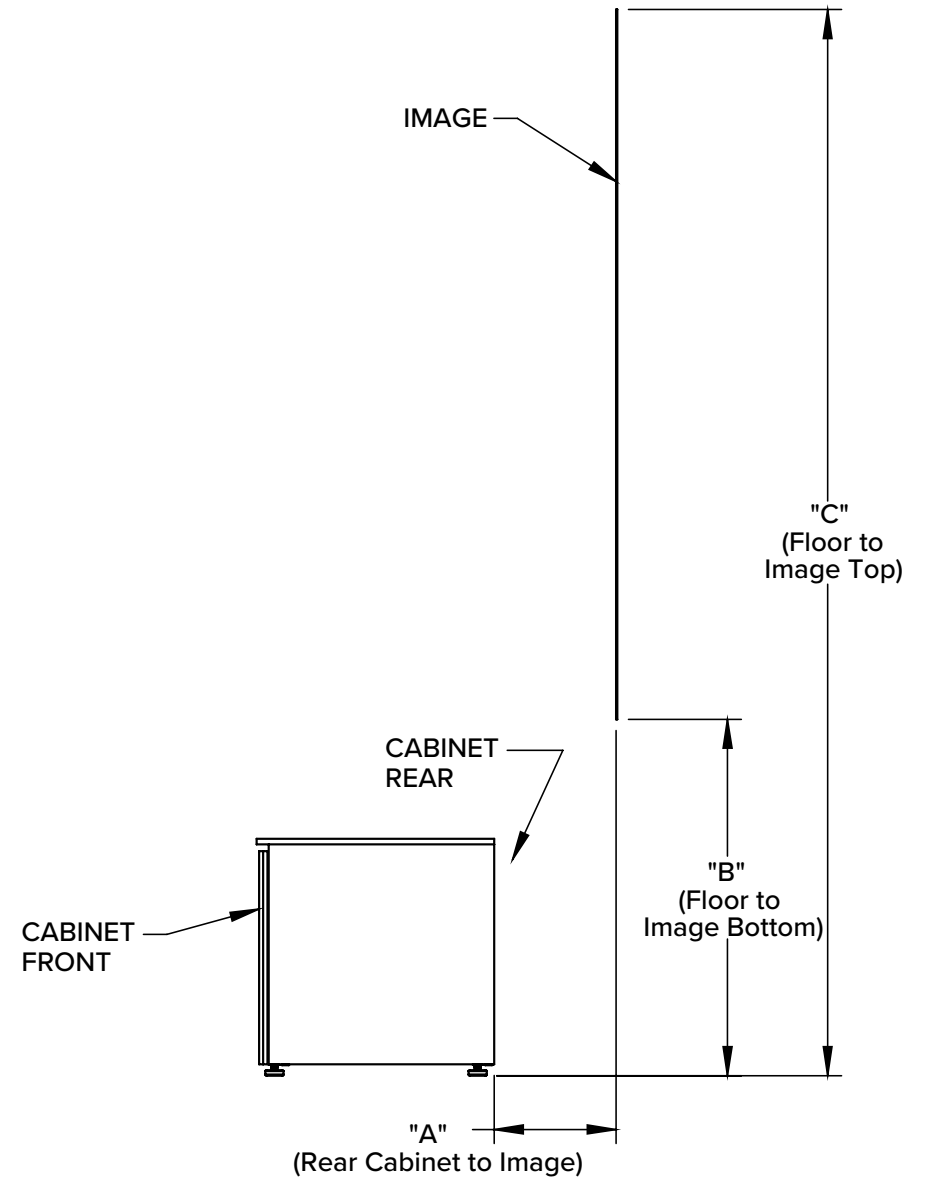

SIDE VIEW
(Cabinet placement / Image Size)