

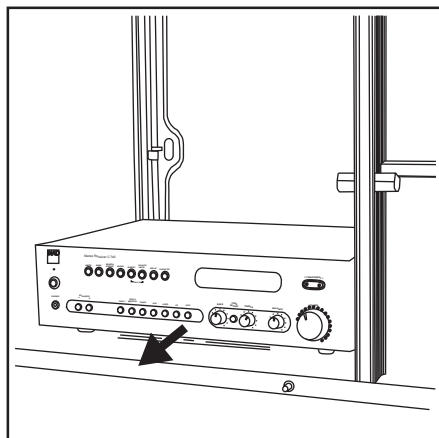

BOTTOM VENT WITH ACTIVE COOLING



1. REMOVE COMPONENTS

Remove components located directly above the passive cooling vent to be replaced.

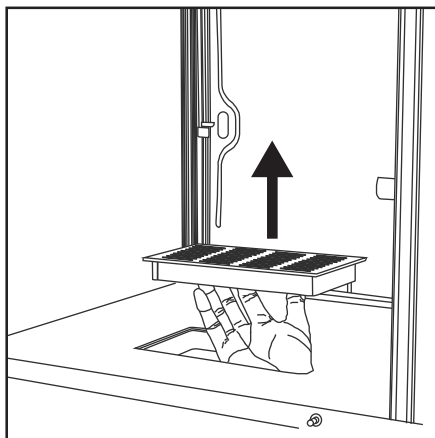

2. REMOVE EXISTING VENT

Remove passive cooling vent by pushing up from underside firmly to break the adhesive bond. Do not pry from the top – this will mar the surface.

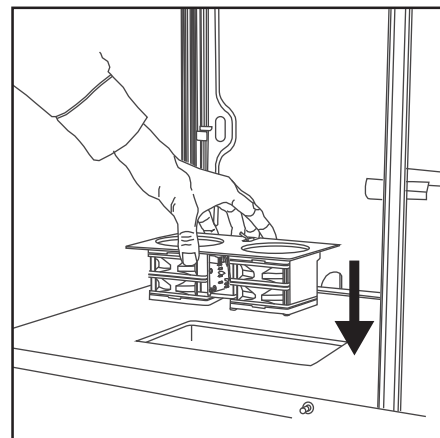

3. INSTALL FAN

Place the fan assembly into the mounting hole guiding the assembly squarely into the recessed area on the back of the faceplate. Adhesive is not necessary for this installation. If desired a light bead of silicone sealer can be used.

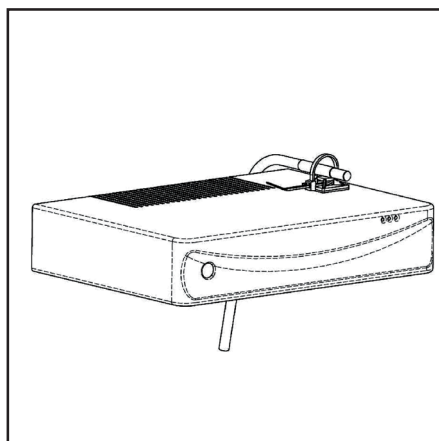

4. ATTACH THERMISTER

Use supplied wire tie to hold Thermister in place on top of the hottest piece of equipment, closest to the heat source. Consider your "always on" components, (i.e. Satellite Receiver, Cable Box).

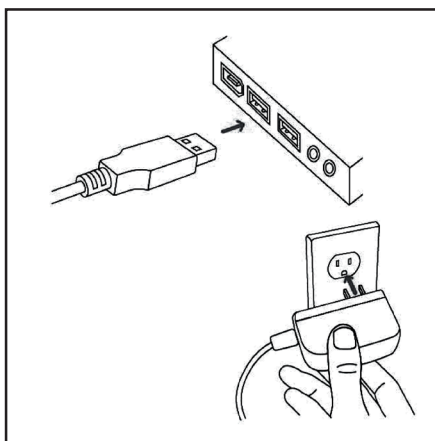

5. AC ADAPTER

Active cooling rear panel is powered by plugging the supplied AC adapter into wall outlet. Up to four fans can use the same A/C wall adapter and/or thermal controller, utilizing in-line female USB plug attached to each unit.

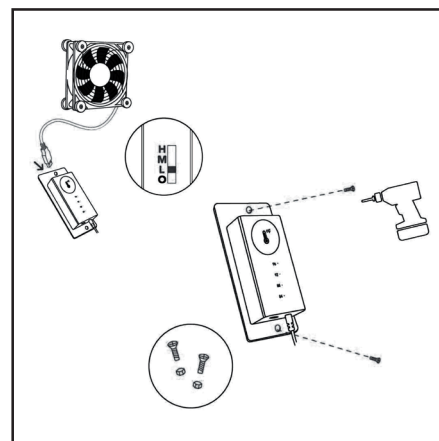

6. MULTI SELECTOR FAN SWITCH

Multi Selector Fan Switch must be set to High when Active Thermal Trigger is used. When not used, switch selects constant "always on" fan speed. Push button to cycle through 4 temperature settings. When all 4 temperature lights are on, "always on" mode is selected. Pressing round button again will turn fans and Active Thermal Trigger off.

*Note: Thermal Trigger can be relocated and attached to desired location using included fasteners.

WARNING ROTATING FANS

Please provide ample clearance from obstructions such as carpet.

Limited Warranty

Salamander Designs will repair or replace any defect in material or workmanship which occurs during normal use of this product with new or rebuilt parts, free of charge in the USA, for two years from the date of original purchase. This is a no hassle warranty with no mail in warranty card needed. This warranty does not cover damages in shipment, failures caused by other products not supplied by Salamander Designs, or failures due to accident, misuse, abuse, or alteration of the equipment. This warranty is extended only to the original purchaser, and a purchase receipt, invoice, or other proof of original purchase date will be required before warranty repairs are provided.

Mail in service can be obtained during the warranty period by calling toll-free (800) 535-5659. A Return Authorization number must be obtained in advance and can be marked on the outside of the shipping carton.

This warranty gives you specific legal rights and you may have other rights (which vary from state to state). If a problem with this product develops during or after the warranty period, please contact Salamander Designs, your dealer or any factory-authorized service center.

www.SalamanderDesigns.com

800-535-5659

Doc No. 501-607v2-19 ©2020 Salamander Designs Ltd.